



Features

- Using Linux operation system. High calculation accuracy, fast data processing speed and friendly user interface.
- Separated design for easy operation.
- Portable design, easy to carry.
- It can measure surface roughness, waviness and primary profile.
- It has a wide measuring range of 1000 μ m and maximum tracing length up to 50mm.
- 5.7 inch TFT LCD screen to clearly display the evaluation curves.
- With touch screen to quickly set the measuring conditions on the screen.
- Mouse operation is supported.
- Store 10,000 groups of measuring conditions and data.
- Measurement data can be stored in U disk.
- Measurement with or without skid.
- Print measurement parameters and profile curves.
- Equipped with optional advanced analysis software.
- Conforming to the roughness standards including ISO 4287-1997; JIS 0601: 2001; ANSI; SEP1941-2012.

TIME® 3234 **NEW**

SURFACE WAVINESS TESTER

Technical Specification

Profile	R, W, P, R-Motif, W-Motif
Measuring parameters	See the Table on Page 34
Filter	Gauss, 2RC
Cutoff l	0.08mm, 0.25mm, 0.8mm, 2.5mm, 5mm, 8mm, 10mm
Evaluation length ln	(1-5)l
Measuring range	1000 μ m (\pm 500 μ m)
Max. resolution	0.0003 μ m
Tracing length	50mm
Tolerance	\pm 5%(Skid), \pm 10%(Skidless)
Repeatability	1.5%(Skid), 3%(Skidless)
Storage	10000 groups of measuring conditions and data
Interface	RS232, USB
Power	Built-in Li rechargeable batteries/ External power adapter
Working temperature	0 $^{\circ}$ C~40 $^{\circ}$ C
Storage temperature	-25 $^{\circ}$ C~60 $^{\circ}$ C
Humidity	<90%
Dimensions(mm)	Main unit: 260 \times 210 \times 68
	Driver: 195.5 \times 60 \times 122
Weight(Kg)	Main unit: 1.5
	Driver: 1.58
Power adapter	Input: 100 V~240VAC, 50/60Hz Output: 9V, 3A

TIME[®] 3234 SURFACE WAVINESS TESTER

Standard Delivery

•Main unit	1
•Driver	1
•Standard pickup	1
•Portable stand	1
•Mini USB cable	1
•Template	1
•Power Adapter	1
•User Manual	1
•TIME certificate	1
•Warranty card	1

Measuring Parameters

Standard	Profile Curves	Parameters
ISO1997	R	Ra, Rq, Rz, Rp, Rv, Rsk, Rku, Rc, RPc *, RSm, R Δ q, Rmr*, Rmr(c) *, R δ c*, Rt, Rz1max, Rk, Rpk, Rvk, Mr1, Mr2, A1, A2, Vo
	P	Pa, Pq, Pz, Pp, Pv, Psk, Pku, Pc, PPc*, PSm, P Δ q, Pmr*, Pmr(c) *, P δ c*, Pt, Pz1max
	W	Wa, Wq, Wz, Wp, Wv, Wsk, Wku, Wc, WPC1, WSm, W Δ q, Wmr*, Wmr(c) *, W δ c*, Wt, Wz1max
JIS2001	R	Ra, Rq, Rz, Rp, Rv, Rsk, Rku, Rc, RSm, RzJIS, R Δ q, Rmr*, Rmr(c) *, R δ c*, Rt
	P	Pa, Pq, Pz, Pp, Pv, Psk, Pku, Pc, PSm, PzJIS, P Δ q, Pmr*, Pmr(c) *, P δ c*, Pt
	W	Wa, Wq, Wz, Wp, Wv, Wsk, Wku, Wc, WSm, WzJIS, W Δ q, Wmr*, Wmr(c) *, W δ c*, Wt
ANSI	R	Ra, Rq, Rz, Rp, Rv, Rsk, Rku, RPc*, RSm, R Δ a, R Δ q, Htp*, tp*, Rt, Rmax, Rpm
	W	Wa, Wq, Wz, Wp, Wv, Wsk, Wku, WPC*, WSm, W Δ a, W Δ q, Htp*, tp*, Wt, Wmax, Wpm

Pickup for TIME[®] 323X



TIME S230 standard pickup

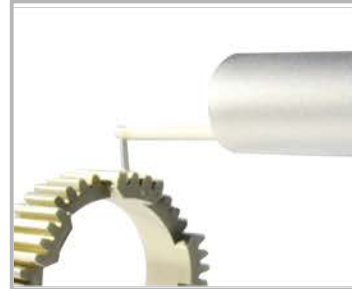

TIME S230V pickup (7mm changeable diameter)



TIME S230U pickup (7mm)



TIME S231 pickup for tooth surface (120° probe)



TIME S232 pickup for small hole (ø1.33)



TIME S233 pickup for deep groove (10mm)



TIME S236 pickup for extra deep groove (20mm)



TIME S238 pickup for super deep groove (30mm)

Pickup for TIME[®] 323X

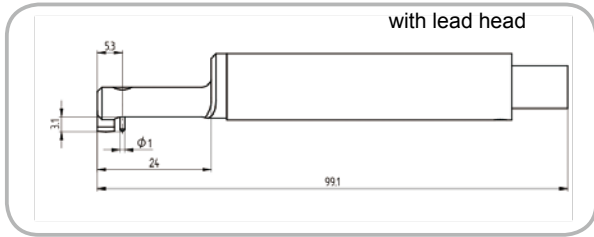

TIME S230 standard pickup

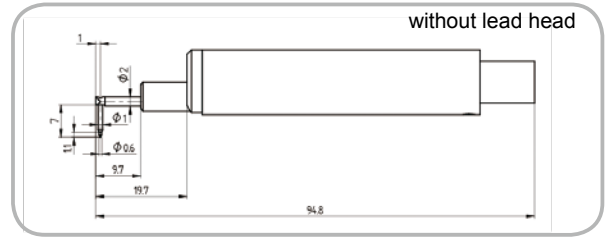

TIME S230V pickup

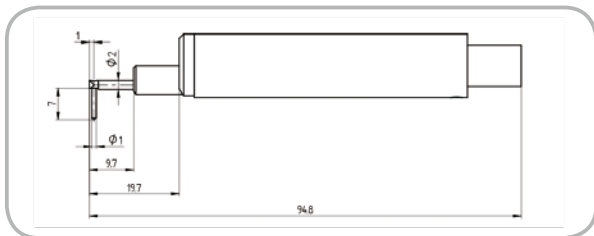

TIME S230U pickup

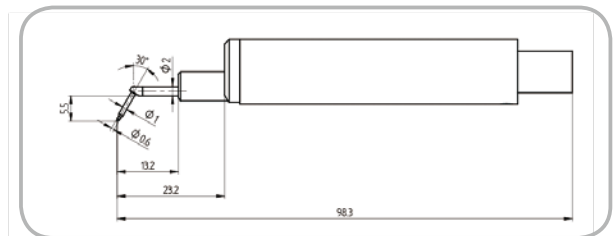

TIME S231 pickup for tooth surface

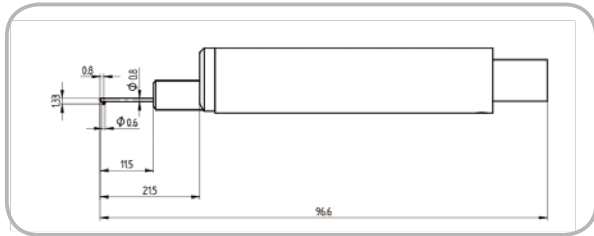

TIME S232 pickup for small hole

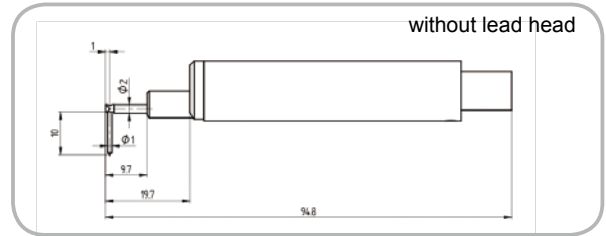

TIME S233 pickup for deep groove

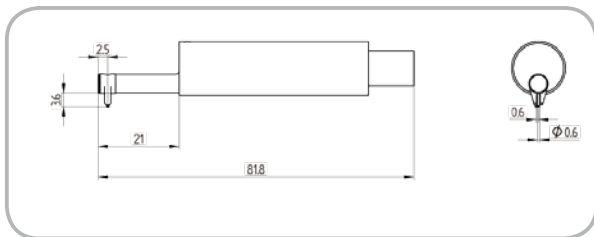

TIME S234 pickup for curved surface

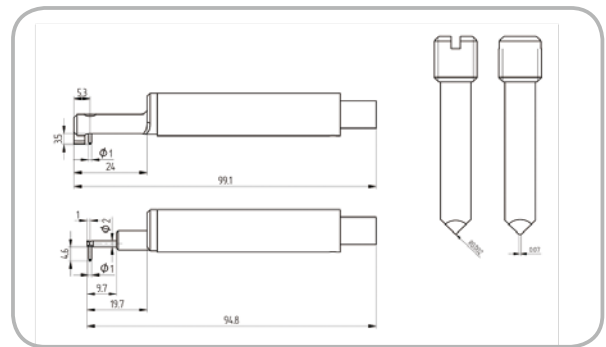

TIME S235 pickup for axe-cutter

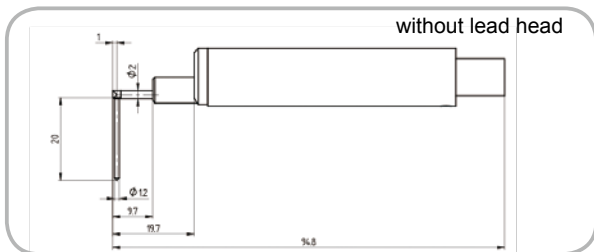

TIME S236 pickup for extra deep groove

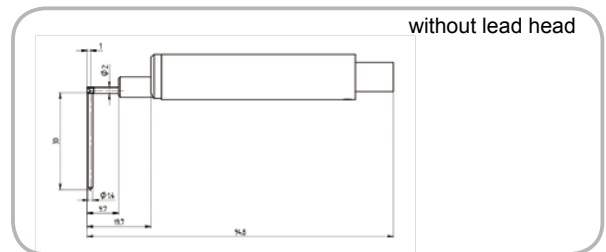

TIME S238 pickup for super deep groove